

Dimensions

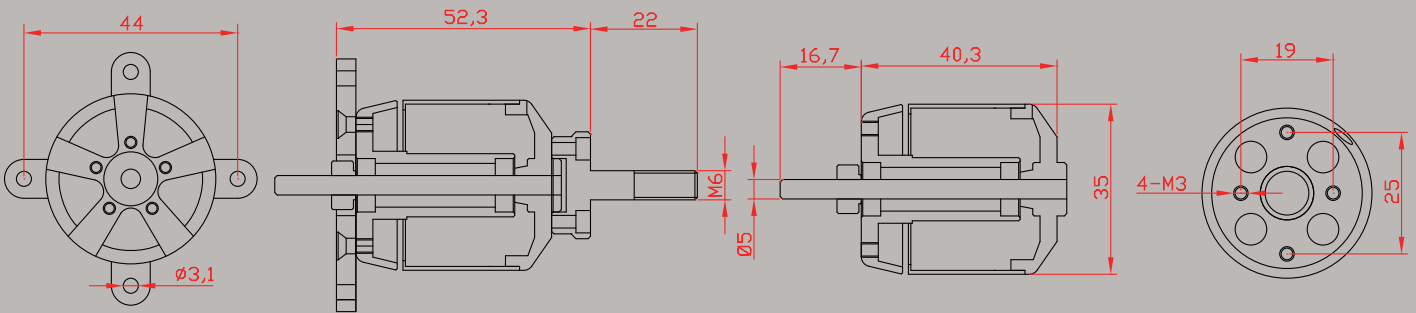

Specification



Dualsky Xmotor CA2 Series	XM3542CA		
Item No.(商品编码)	55128	55129	55130
Model - Turns(马达转速)	XM3542CA-5	XM3542CA-6	XM3542CA-7
RPM/V(KV)(KV值)	1120	940	800
Stator Diameter(定子直径)	28	28	28
Magnet length(磁铁长度)	20	20	20
Shaft diameter(轴径)	5	5	5
Mountingholes pitch(安装孔距)	19/25	19/25	19/25
Weight(g)(重量)	137	137	137
Resistance(Ri)(mOhm)(电阻)	27	36	51
Idle Current(Io) @10V (A)(空载电流)	2.11	1.62	1.64
No.of Cells(LiPo)(电池节数)	2..3	2..3	3..4
Max. EfficiencyCurrent[A](效率电流)	28	25	22
Max. Burst Current (15s)[A](最大电流)	38	36	34
Max. Power(15s)(最大功率)	450W	450W	450W
Input Connectors[mm](金插)	DB3	DB3	DB3
Recommended ESC(推荐调速器)	XC4018BA	XC3012BA	XC3012BA
Prop. Range(螺旋桨)	9x5...12x6	8x6...14x6	8x6...14x6
App. Class(适用机种)	.15-.21 Class		